



Barnfield Road

Harpenden, AL5 5TH

A beautifully presented period semi-detached family home that benefits from a South West facing garden. This fine home has been recently renovated and redecorated to high standard throughout by our clients and features a standout master suite on the top floor with stunning views. Close to both the amenities of Southdown and excellent schooling.

Guide price £950,000

Barnfield Road

Harpenden, AL5 5TH



- Immaculately presented
- Recently redecorated by our clients including a fabulous master suite loft conversion
- Open plan Kitchen / Diner / Family Room
- Character features throughout
- Walking distance to the common and station
- South West facing Garden
- Close to amenities of Southdown
- Well located for schooling
- Council Tax Band F

Entrance Hall

Living Room

13'3" x 12'5" (max) (4.04 x 3.80 (max))

Kitchen / Diner

17'3" x 16'1" (5.28 x 4.92)

Family Room

12'1" x 11'2" (3.69 x 3.41)

Cloakroom

Bedroom One

18'5" x 11'1" (5.61m x 3.38m)

En-suite

Store

Bedroom Two

12'3" x 11'2" (3.73m x 3.40m)

Bedroom Three

11'5" x 11'2" (3.48m x 3.40m)

Bedroom Four

7'7" x 7'7" (2.32 x 2.32)

Bathroom



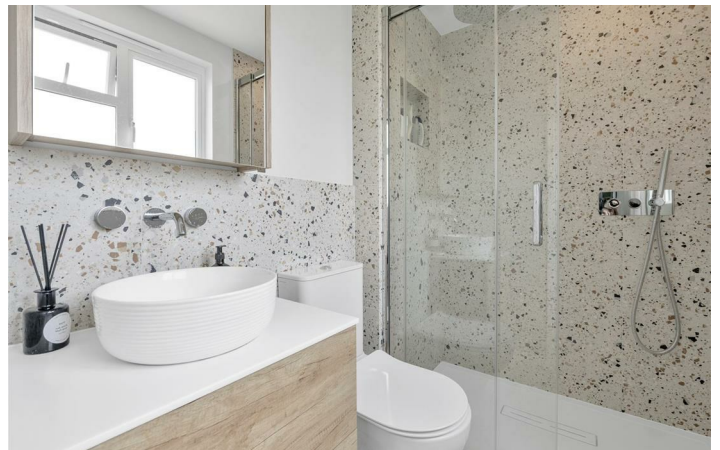

Floor Plan

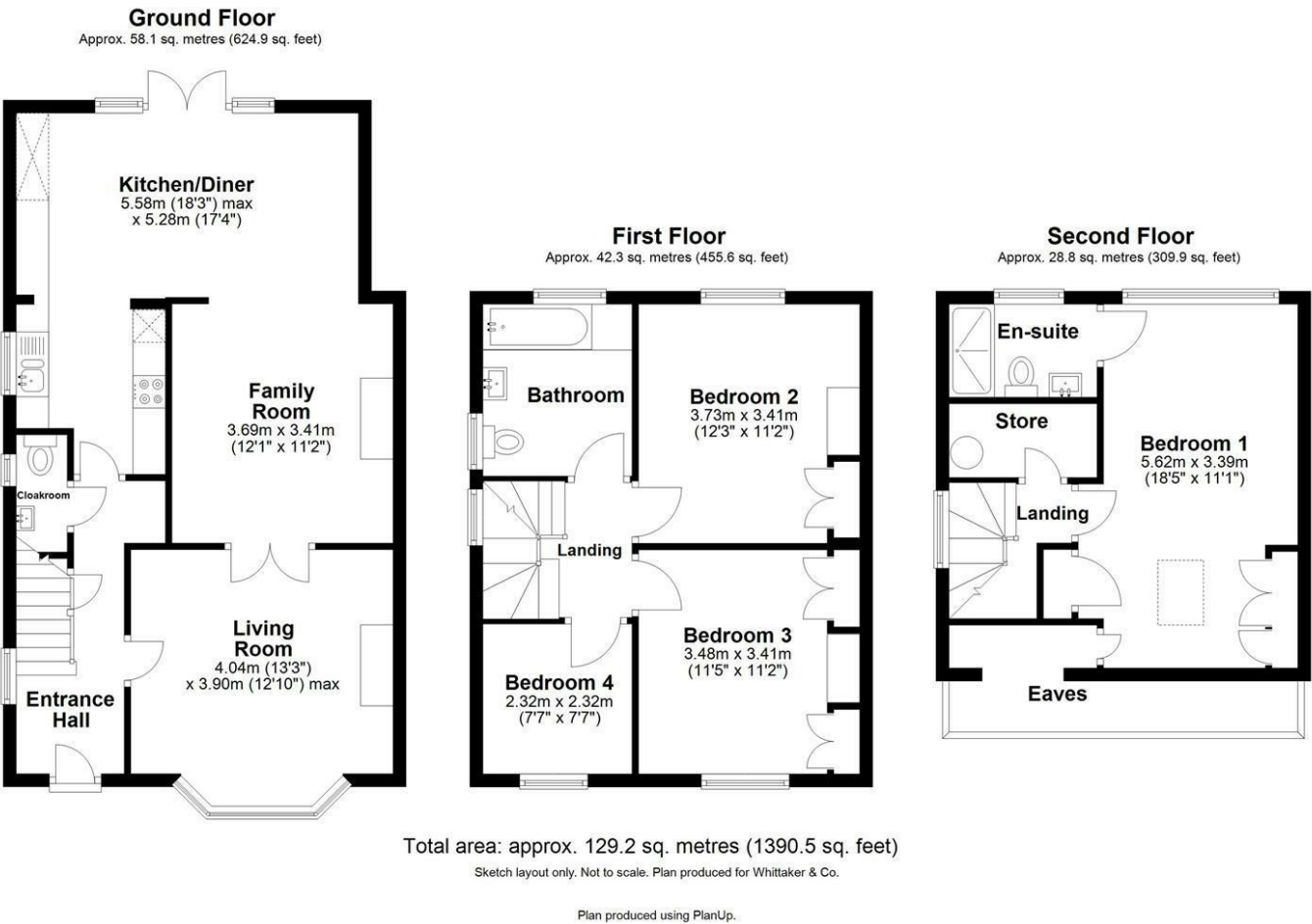

These particulars, whilst believed to be accurate are set out as a general outline only for guidance and do not constitute any part of an offer or contract. Intending purchasers should not rely on them as statements of representation of fact, but must satisfy themselves by inspection or otherwise as to their accuracy. No person in this firms employment has the authority to make or give any representation or warranty in respect of the property.

